



THE ENCLAVE  
— OF EAST LOUISVILLE —  
SENIOR LIVING

LIVE THE LIFE YOU SO  
RICHLY DESERVE.



# A NEW WAY TO FEEL MORE AT HOME.

---

In many ways, life at The Enclave of East Louisville is just what you would imagine. Spacious apartments. A caring staff. The beautiful Kentucky surroundings. But it only takes a slightly deeper look to discover that it offers all those things and so much more.

The Enclave of East Louisville is operated by Bridge Senior Living, which means we go beyond the expected. We strive to care more. To innovate more. To inspire more. All to help you create a lifestyle that is as abundant and fulfilling as you dare to dream.





# THE BEAUTY OF KENTUCKY INSIDE AND OUT.

---



The Enclave of East Louisville is tucked in a tree-lined area along the eastern edge of Louisville proper. But its location is just as convenient as it is peaceful, so you're never far from whatever you want – be that a relaxing night at home or an evening show in town.



## Where are we?

100 Shelby Station Drive  
Louisville, KY 40245  
866-531-4791





IMAGE OF THE LOUISVILLE, KY SURROUNDING AREA

A woman with her hair in a bun is hugging an elderly woman from behind. The elderly woman has short, light-colored hair and is wearing a patterned top. The woman hugging her is wearing a dark top. The background is a blurred indoor setting. The entire image is overlaid with a semi-transparent dark blue filter.

# A SANCTUARY FOR EVERY SEASON.

---

**On the journey of life, we sometimes get to choose our paths, and sometimes we encounter unexpected detours that lead to new adventures.**

As a Bridge Senior Living community, The Enclave of East Louisville helps create rewarding lifestyles for all our residents. With Personal Care, Memory Care and Respite Care options, along with round-the-clock expert health services and support, life here always fosters a sense of serenity, safety, and satisfaction.



**Your desire to stay active can still be fulfilled, thanks to the expert care of The Enclave of East Louisville's friendly professionals.**

## PERSONAL CARE

---

### **A helping hand toward a happier life.**

With the support of friends and family, aging successfully is rarely a solitary achievement. But sometimes, the need for more consistent help arises. Fortunately, your desire to stay active can still be fulfilled, thanks to the expert care of The Enclave of East Louisville's friendly professionals.

Naturally, help is available daily, so your security is ensured. We also feature an emergency response system, daily check-ins, and a medication management service so you never have to worry about what to take or when.

***A few other common ways our associates assist with daily activities include:***

- ***Assistance with bathing and dressing as needed***
- ***Help getting in and out of bed***
- ***Help getting to meals and other activities***
- ***Additional assistance at mealtime if needed***
- ***Discreet Personal Care whenever needed***

For Personal Care residents, we offer four floor plans from deluxe studio/1-bath to 2-bedroom/1-bath layouts.

Like all of our apartments, they feature an open, as happy a community as possible.

**Starting at \$4,895**  
All apartments include:

- Individual thermostat controls
- Modern kitchens with full-size appliances
- Washers and dryers in each apartment
- Utilities (electricity, water, telephone)
- Housekeeping
- Trash service
- Pest control
- No property taxes

Of course, they're pet-friendly too.

\*Additional costs may apply.

**Deluxe Studio**

0 Bedroom/1 Bath



**One-Bedroom Apartment**

1 Bedroom/1 Bath

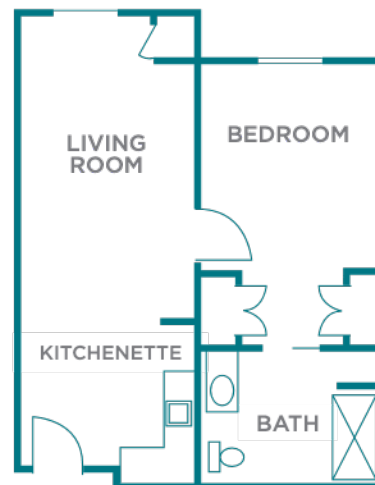



**Deluxe One-Bedroom Apartment**

1 Bedroom/1 Bath



**Two-Bedroom Apartment**

2 Bedroom/1 Bath

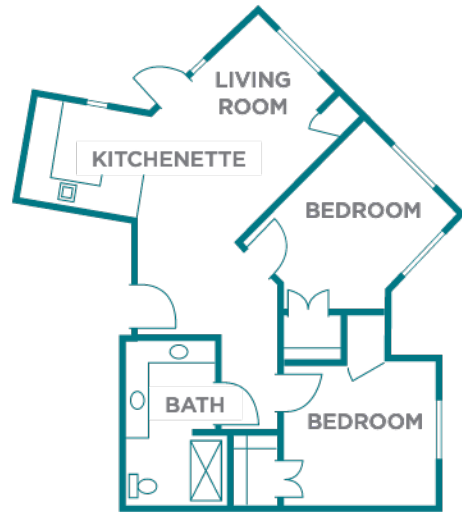

# MEMORY CARE

---

## **Making the most of every day.**

If you have a loved one experiencing cognitive issues, it's encouraging to know there's a place like The Enclave of East Louisville. A place where every day is designed to be as positive and productive as possible. To help ensure that happens, every staff member on our Memory Care team undergoes specialized training, resulting in a combination of expert care and extraordinary empathy that both your loved one – and your entire family – will appreciate.

***Some features of our Memory Care living include:***

- ***Daily on-site support of trained staff***
- ***Nutrition management***
- ***Assistance, including extra social and one-and-one time, to help each resident experience as much joy as possible every single day***
- ***Emotional support using proven techniques individualized for each resident***
- ***Family-centered consultation and involvement to help achieve consistently better outcomes***



## Memory Care apartments are available in two studio/1-bath floor plans.

They are designed to facilitate the highest levels of safety and care.

**Starting at \$5,795**  
All apartments include:

- Individual thermostat controls
- Modern kitchens with full-size appliances
- Washers and dryers in each apartment
- Utilities (electricity, water, telephone)
- Housekeeping
- Trash service
- Pest control
- No property taxes



### Studio

0 Bedroom/1 Bath

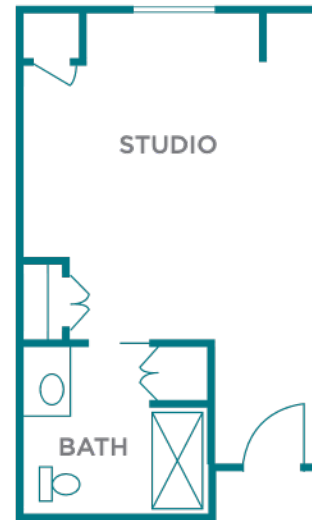

### Companion

0 Bedroom/1 Bath

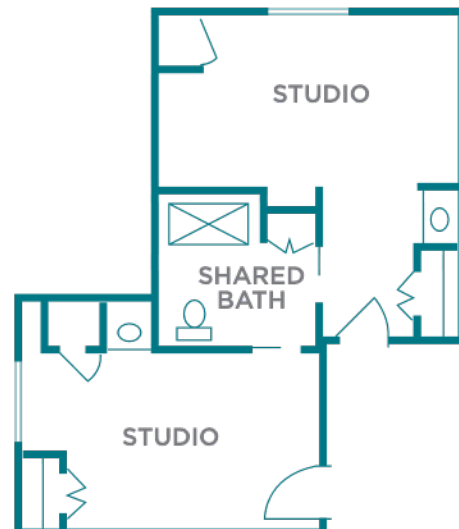

A woman in a patterned dress is hugging a caregiver in a white uniform. The scene is set in a bright, indoor environment, likely a senior living community. The image is overlaid with a dark blue semi-transparent layer.

# IT'S WHAT'S ON THE INSIDE THAT COUNTS.

---

When you're considering a senior living community, there are certain "must-haves." A choice of spacious apartments. A compassionate staff. Inviting meals you can look forward to. Outstanding care whenever care is needed.

At The Enclave of East Louisville, we agree that these are, indeed, "must-haves." But as a Bridge Senior Living community, being great at those things is just the starting point, not the finish line. Because a great life demands more – much more – than simply being "good enough."

# A FEAST FOR THE BODY AND THE SOUL.

---



If food is the foundation of healthy living, mealtimes may just be the foundation of a healthy community. After all, breaking bread with friends and family has been a principal way of building relationships, stirring the heart, and sharpening the mind throughout history.

**At The Enclave of East Louisville, we take the joy of mealtimes seriously. Our dining services feature restaurant-quality, chef-prepared meals.**

You'll always find something that reminds you of the best home cooking you've ever had, as well as options that may open new culinary doors. Of course, whatever you prefer, every meal will be delicious, nutritious, and customizable to your dietary needs.



Grow as a person, build stronger relationships, deepen your spirituality, expand your knowledge, and live with purpose.

## ALL IT TAKES IS A SINGLE SPARK.

---

Will you find outstanding amenities at The Enclave of East Louisville? Of course. How about activities? More than space here will allow us to describe. But before we talk about those, let's talk about this: Discover Your Spark™.

Discover Your Spark was developed by Bridge Senior Living to help our residents rekindle old hobbies and ignite new passions — to understand what styles and types of activities they enjoy the most and then suggest new avenues of exploring those passions from all angles. So you not only stay active, but you also grow as a person, build stronger relationships, deepen your spirituality, expand your knowledge, and live with purpose.

Our residents truly love Discover Your Spark and we believe you will, too. We also think you'll love all the wonderful amenities and activities you'll find at The Enclave of East Louisville, including:

- **Studio, one-bedroom, two-bedroom, and companion apartment living options**
- **Personal Care apartments feature kitchenettes**
- **Apartments feature wheelchair-accessible showers**



- **All-inclusive utilities, cable, and wireless access**
- **Barbershop and salon with hair styling and manicures (additional charges apply)**
- **On-site fitness center with physical, speech, and occupational therapy services available**
- **Pet-friendly**
- **Medication management program**
- **Scenic walking trails**
- **Relaxing courtyards**
- **Scheduled transportation to off-site appointments and events**
- **Daily safety checks for all residents**
- **Convenient in-house pharmacy**
- **Licensed nurse available daily**
- **Movie theatre**
- **Healthcare benefit**

# MORE THAN A TOUCH OF USEFUL TECHNOLOGY.

---

While it may be great fun to reminisce about days gone by, few of us would care to return to using party-line telephones or adjusting rabbit ears on the ole television.

**At The Enclave of East Louisville, we don't just welcome the march of technological progress – we join in the innovation parade.**



From apps to virtual tours, here are a few of the ways we're making our residents' lives better via high-touch, high-tech solutions:

## **Bridge Senior Living App**

The Enclave of East Louisville is operated by Bridge Senior Living. So, naturally, we use the Bridge Senior Living App. Powered by LifeLoop, this app offers a central hub for residents, their families, friends, and staff to stay connected by sharing personalized activity schedules, photos, messages, and more.

## **Telehealth**

The era of doctors making house calls is back – at least virtually. Not only do we offer technical support for your telehealth appointments, we even conduct appointments in the privacy of your room or apartment. It's convenient, safe, and thorough. Just what the doctor ordered.

## **Virtual Tours**

While we'd love to have you visit The Enclave of East Louisville in person, we know finding the time to do so may be a bit of a challenge. So instead of waiting for a hole in your schedule to open up, feel free to take a virtual tour. Our community has been digitally scanned and recreated in an easy-to-navigate 360-degree setting, so you can wander the halls, explore the rooms, and check out the grounds from the comfort of your own home.

# BRIDGE SENIOR LIVING MAKES ALL THE DIFFERENCE.

**BRIDGE  
SENIOR  
LIVING** The Enclave of East Louisville is operated by Bridge Senior Living, recognized as one of the most innovative, senior living community management companies in the United States.

Beyond developing forward-thinking initiatives, such as the Bridge Senior Living App and Discover Your Spark™, Bridge Senior Living stands apart for its commitment to resident safety with the Bridge Safe program. Bridge Safe ensures that we have enhanced safety protocols in place to protect our residents and the resources to put those protocols into practice. From enhanced cleaning and guest screenings to daily check-ins to enhanced air filtration, Bridge Safe helps keep The Enclave of East Louisville as happy a community as possible.



Bridge Senior Living continues to pursue improvements and innovations across all aspects of community life. We're proud to be part of their family and welcome the opportunity to tell you more about how Bridge makes life at The Enclave of East Louisville better every day.





## AN HONEST DISCUSSION ABOUT FINANCIAL MATTERS.

---

**At The Enclave of East Louisville, we understand that the costs associated with moving into a senior living community are one of the main concerns for potential residents and their families.**

So we're very upfront with our prices and invite you to contact one of our expert associates with any questions you may have.

Apartments at The Enclave of East Louisville start at \$4,895 per month for Personal Care and \$5,795 per month for Memory Care. These prices are

inclusive of rent, meals, utilities, maintenance, and housekeeping. Plus, you don't have to pay any property or real estate taxes.

There are many options when it comes to financing a life at The Enclave of East Louisville, including retirement savings, proceeds from selling your existing house, selling stocks and securities, etc. The options aren't quite limitless, but they are numerous. So again, we invite you to contact one of our experts to discuss matters further. And it truly will be a discussion and not a sales call. We promise.





## WHAT ELSE WOULD YOU LIKE TO KNOW?

---

Seriously, we'd really love to hear from you and help you learn even more about what makes The Enclave of East Louisville such a wonderful place. Yes, everyone here may be a bit biased, but we believe residents and staff alike would tell you that being a part of this community was the right decision for them.

Is it the right decision for you? That's not for us to say. After all, everyone's needs and situations are different. But you'll never know for sure unless you stop by and take a look around for yourself, which you are cordially invited to do.

**To schedule your own visit at The Enclave of East Louisville, please call 866-531-4791.** We promise it will be a zero-pressure experience.

**Take a tour, meet some residents, meet the staff, ask all the questions you like – even enjoy lunch if you time it right! Just give us a call and we'll make it happen.**

**To schedule a visit or for more information about The Enclave of East Louisville, call 866-531-4791.**

**The Enclave of East Louisville  
100 Shelby Station Drive  
Louisville, KY 40245**